

# CR-3100 SERIES ASSEMBLY DRAWING (RoHS)

Rev.A0

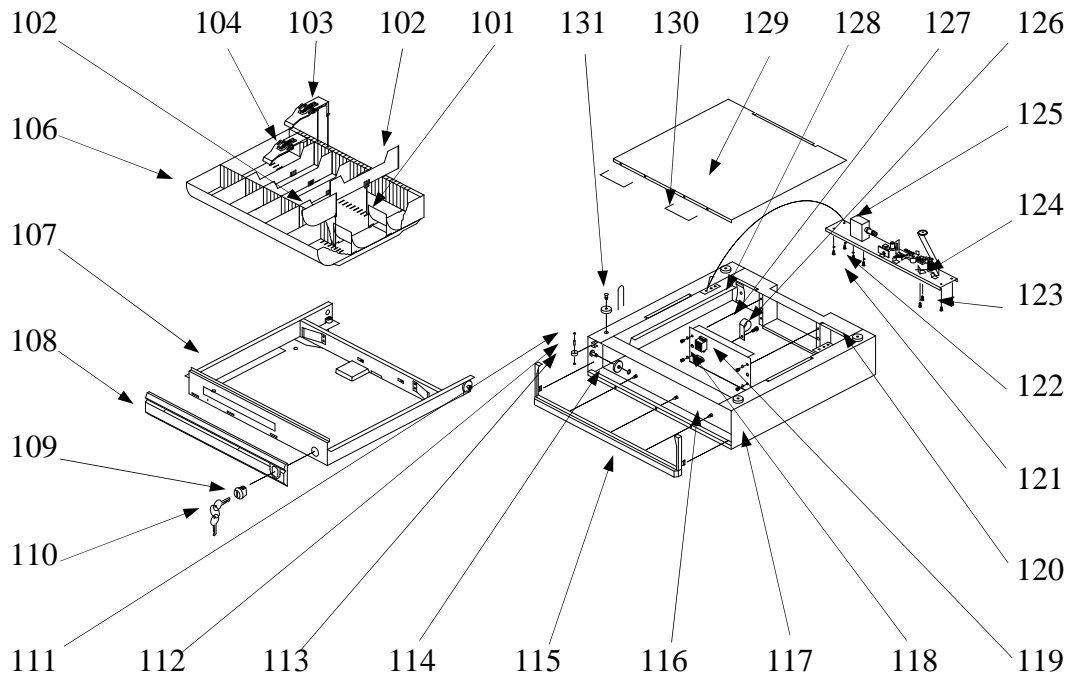

## CR-3100 SERIES SPARE PARTS LIST

The column "Pos." in the list below refers basically to the ID numbers indicated in the Assembly Drawing. If this column is not available, it refers to a packaging item. The column "S." indicates the alternative selections available for that position. (Revised: 2009/7/23)

Pos.	S.	Part Number	Description
101	1	19210315013	Coin Compartment, Black
102	2	19210314013	Separator Kit, Black (Inc. : Bill Separator x 4 Pcs & Coin Separator x 6 Pcs)
103	1	39216001000	Bill Weight Assembly
104	1	10122200001 MSPRNCR21BIL-3	Tension Spring for Bill Weight
106	1	19210306013	CR3100 Cash Tray Assembly, Black
107	2	39216005013	CR3100 Tray Frame Assembly For System, Black(w/ Lock)
108	1	19210318113	CR3100 Front Panel, Posiflex Brand, Black
	2	19210318106	CR3100 Front Panel, Posiflex Brand, Ivory
	3	19210308002 MCR31FNTPN-1-C	CR3100 Front Panel, No Brand, Charcoal
	4	19210318006	CR3100 Front Panel, No Brand, Ivory
109	1	10171003000 MCR210CMLCK	Lock
110	1	10172007000	Key for CR-3100 ( 2 Pcs/Set)
111	1	10430025042 MERIN2.5	E-ring D2.5
112	1	19210201000 MPLSTCROLD12	Shaft Roller
113	1	19210309000 MSHAFTD3*14	D3*14 Shaft Roller
114	1	19210310000 MPLSTCBR NGD19	Bearing D19
	2	MERIN4.0	E-ring D4.0
105	1	19210317013	CR3100 Upper Bracket, Black
	2	19210317006	CR3100 Upper Bracket, Ivory

116	1	10591003102 MSTSCRW3-10+R	Round Head Self-Tapping Screw 3*10L
117	1	19210108013	CR3100 Upper Chassis for System, Black
	2	19210108016	CR3100 Upper Chassis for System, Ivory
118	1	21861018120	8P Telephone Jack w/ Wire for CR3100/3200
119	1	39224000000 CR310 REARPLT	CR3100/3200 Back Plate w/ telephone Jack Assembly w/o Interface Cable
	2	49220662000 CR3101MODUL	CR3101/3102/3103/3201/3202/3203 Back Plate w/ Control Module w/o Cable
	3	39224002000 CR310 REARPLT-4	CR3104/3204 Back Plate Assembly w/ Interface Cable w/o Power Cable
	4	49210601200	CR3104/3204 Control Module
120	1	39246005000 MRUBFT19*5F+M	Chassis Foot Set
121	1	10501003062 MSCRWM3-6+R	Round Head Screw M3 * 0.5 * 6L
122	1	10501030062	Pan Head Screw M3-6L
123	1	10684038062	Binding Head Screw #6/32-6L
124	1	39224003000 CR310 MECHCTRL	CR3100/3200 Control Mechanism Assembly for System
	2	39224004000 CR310 MECHCTRL1	CR3101/3102/3103/3201/3202/3203 Control Mechanism Assembly w/ Internal Cables (2 x
	3	39224005000 CR310 MECHCTRL4	CR3104/3204 Control Mechanism Assembly w/ Internal Cable (CCBLA-139) for System
125	1	10381210813	Solenoid w/o Cable
126	1	10684038103	Binding Head Screw #6/32-10L
127	1	10241304000 MCBLHOD19	Cable Holder
128	1	19210105000 MCR21 BKCUSNPLT	Rear Cushion
129	1	19210103000 MCR21 BTMPLT	CR3100 Bottom Plate
130	1	19210104000 MCR21 ZNW.8*110	Bottom Plate Fixing Wire

131	1	19210106000 MCR21 FRTCUSN	Front Cushion
	1	10331495505 CPEBAG49*55	PE Bag for CR3100/3104
	1	19210512120 CEXCTNCR3100P2	External Carton for CR3100/3104
	1	19210541020	PE Foam in Pair for CR3100/3104
	1	19210900011 CMANUCR3104/320B	User' s Manual for CR3100/3200/3104/3204
	1	21863218010	Interface Cable for CR3100/3200, Black
	2	21863018010 CCBLA-180-1	Interface Cable for CR3100/3200, Ivory
	1	21863007701 CCBLA-077-1	CR3101/3102/3201/3202 Serial Interface Cable 190 cm, Ivory
	2	21863231810	CR3103/3203 Parallel Interface Cable, Black
	1	21867014010 CCBLA-140A	CR3104/3204 Serial Interface Cable From Inside, Ivory
	1	21973012151 CADPTR12V1.5A120	12V AC Adaptor for CR3101/3102/3103/3201/3202/3203 for USA
	2	21973012152 CADPTR12V1.5A230E	12V AC Adaptor for CR3101/3102/3103/3201/3202/3203 for Europe
	3	21973012154 CADPTR12V1.5A230K	12V AC Adaptor for CR3101/3102/3103/3201/3202/3203 for UK
	4	21973012155 CADPTR12V1.5A240S	12V AC Adaptor for CR3101/3102/3103/3201/3202/3203 for SA
	5	21973012156 CADPTR12V1.5A245C	12V AC Adaptor for CR3101/3102/3103/3201/3202/3203 for CHN
	6	21973012123 CADPTR12V1.2A240A	12V AC Adaptor for CR3101/3102/3103/3201/3202/3203 for AUS
	1	39454001000 DC12VPWRKIT	Power Kit to get 12 V Power from Usual PC for CR3101/3102/3103/3201/3202/3203
	1	39214001000 CCBLA-141 + CSLPLTCR2104	Power Kit to get 12 V Power from Usual PC for CR3104/3204